

100
0 10
Millimetres

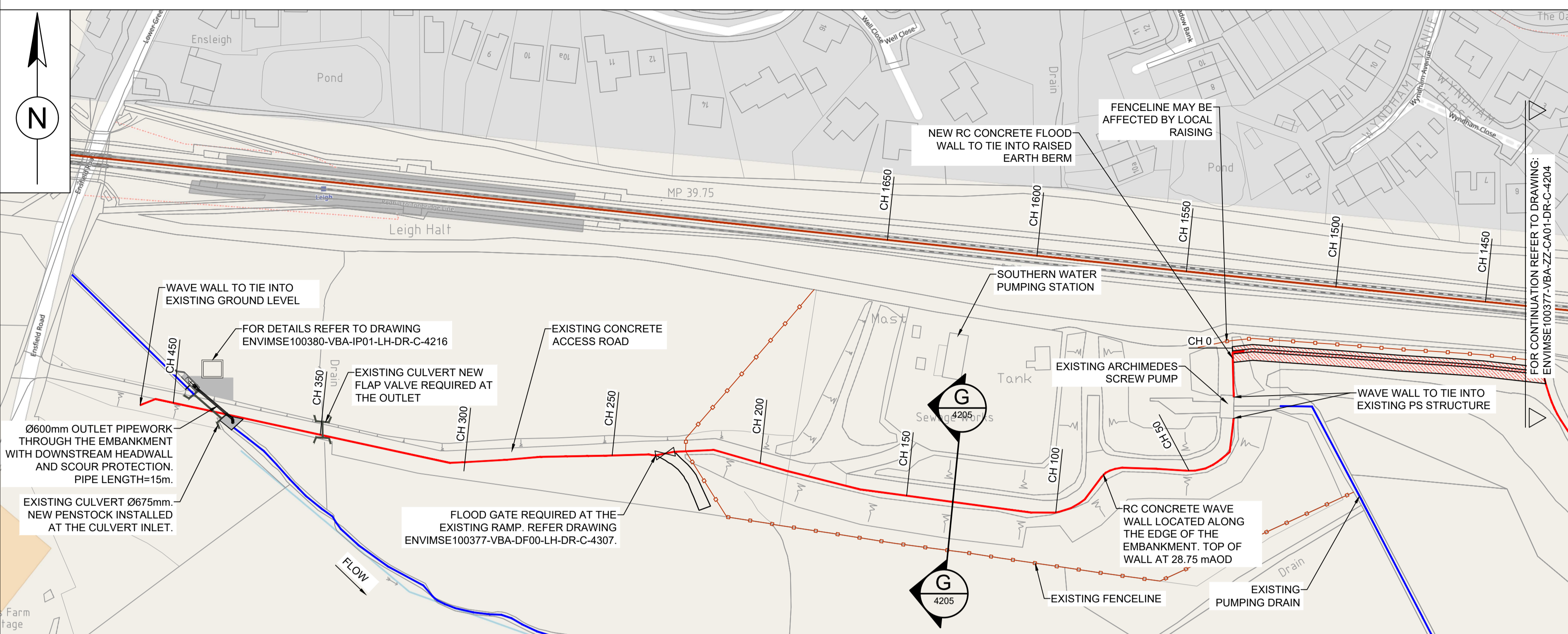

PAULS FARM EMBANKMENT
SCALE 1:1000

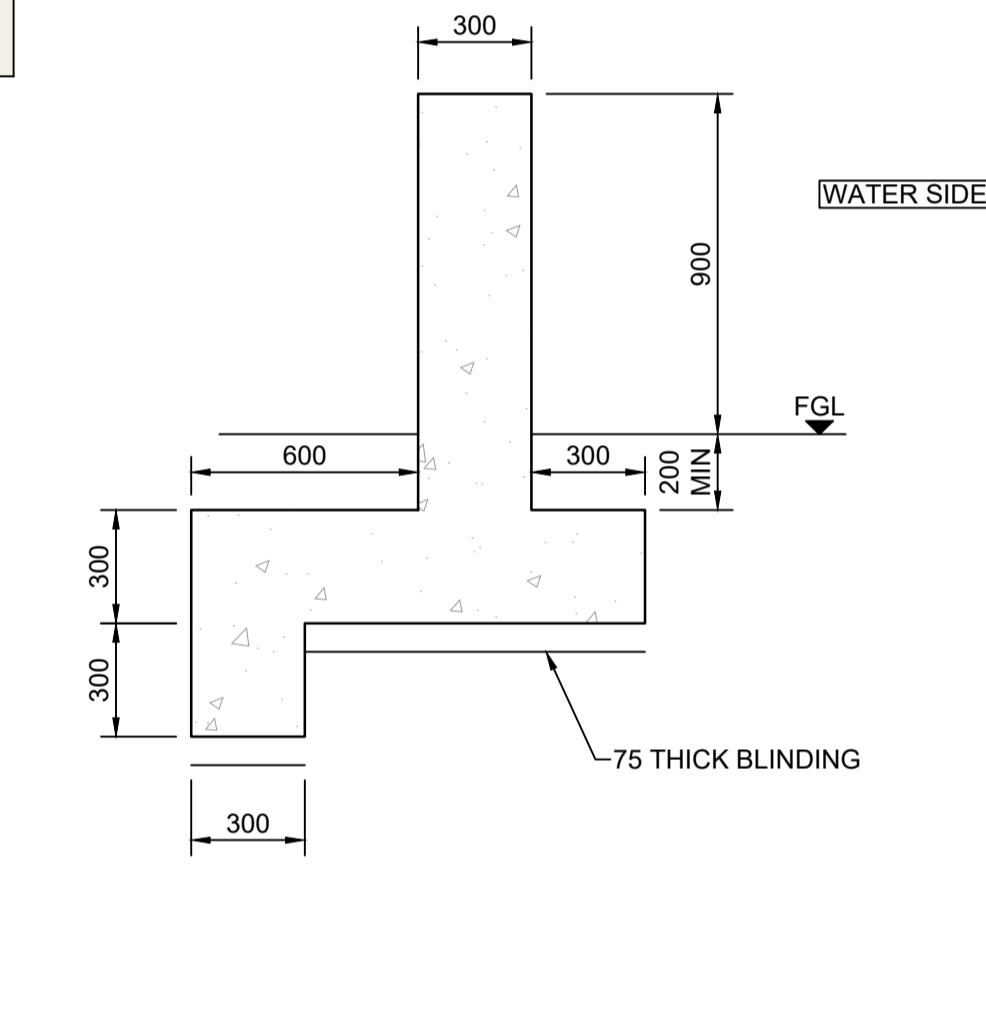
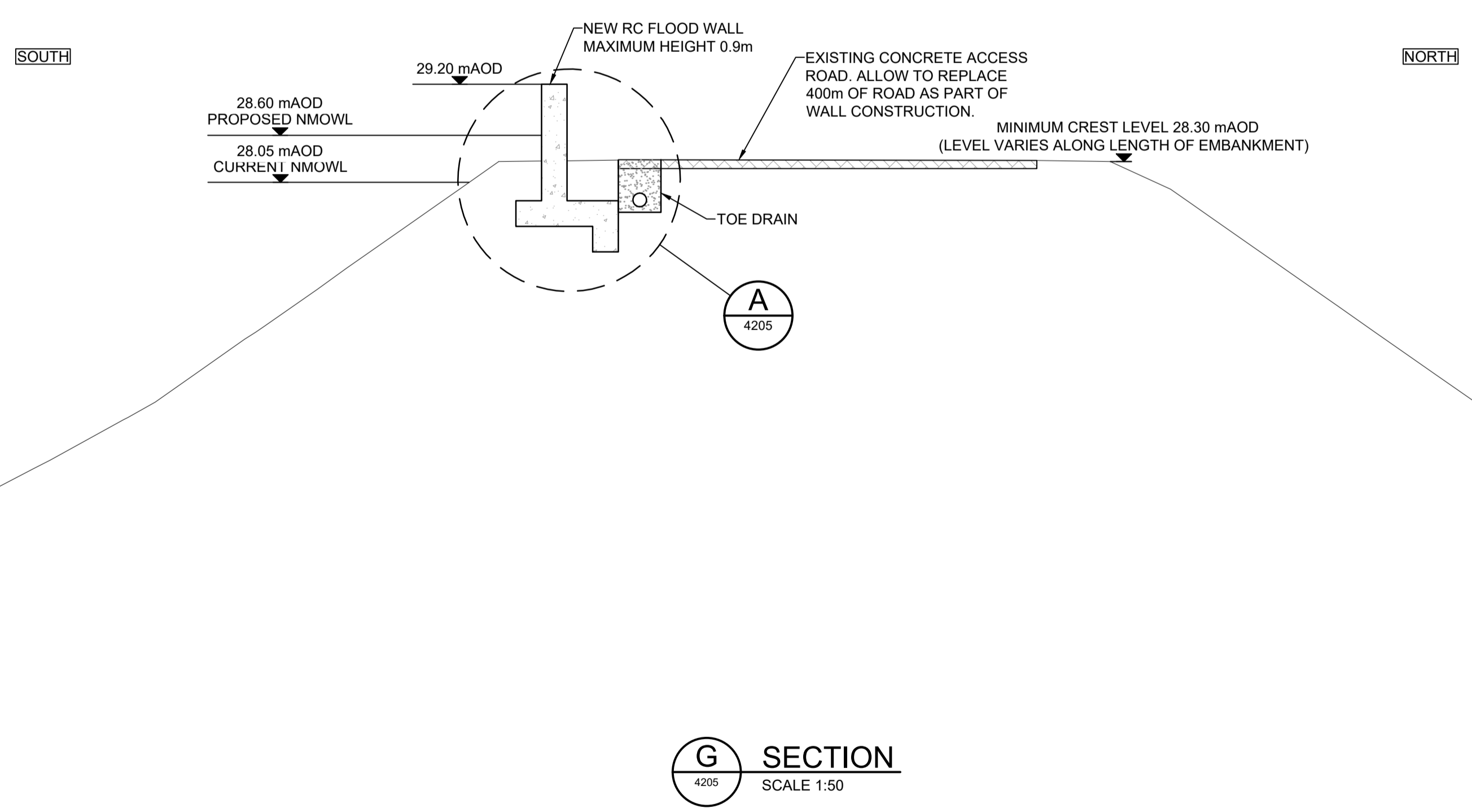

A TYPICAL 0.9m HIGH WALL
SCALE 1:20

DO NOT SCALE

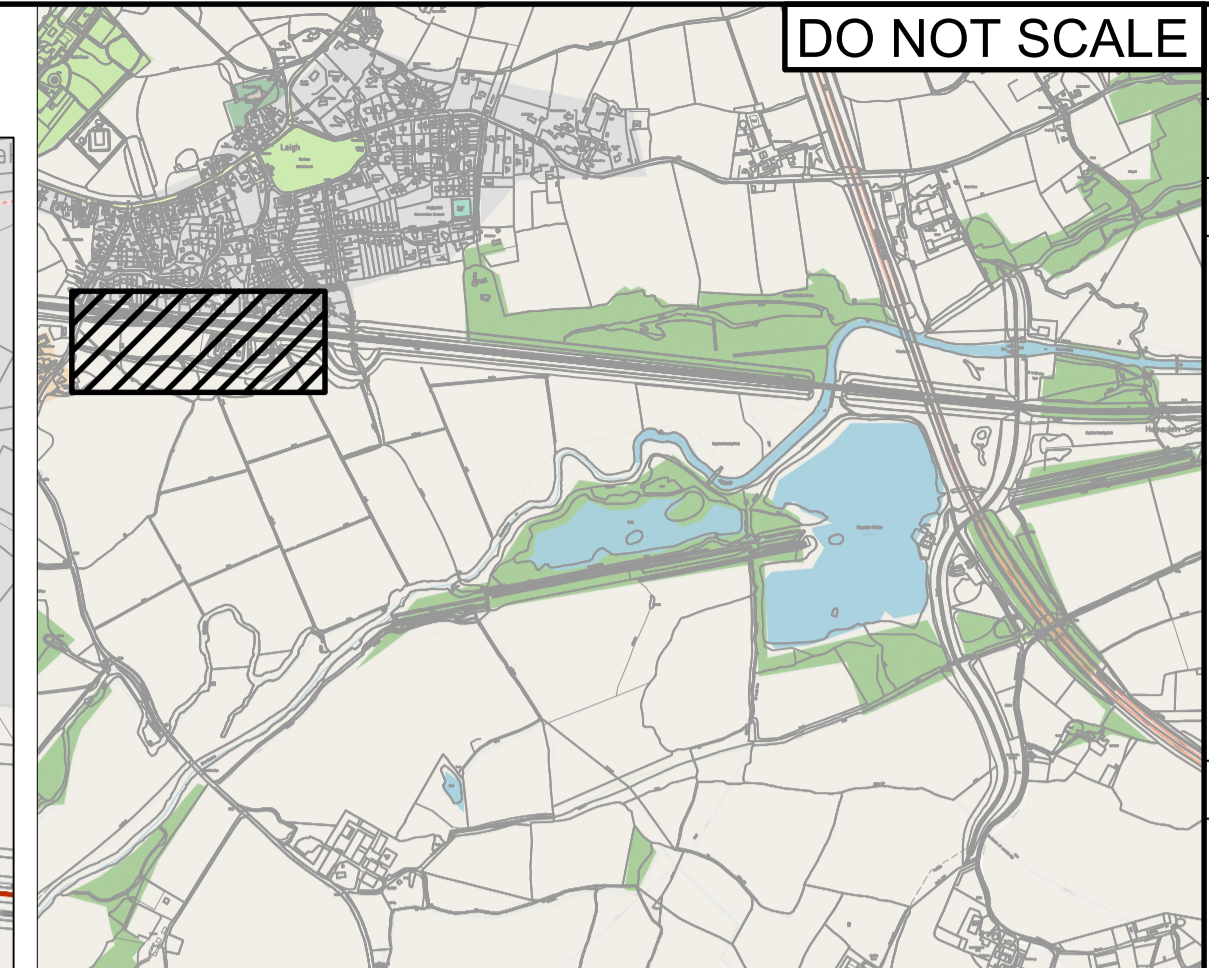

SAFETY, HEALTH AND ENVIRONMENTAL INFORMATION

In addition to the hazards/risks normally associated with the types of work detailed on this drawing, note the following:

- CONSTRUCTION**
- ZZ - 1.10: SITE DELIVERIES / ROAD TRAFFIC THROUGH LEIGH VILLAGE - CONSTRUCTION TRAFFIC THROUGH LEIGH VILLAGE CAUSING DISRUPTION TO LEIGH PRIMARY SCHOOL AND INCREASED RISK OF INJURY TO PEDESTRIANS.
 - NR - 3.01: WORKING IN THE VICINITY OF AN ACTIVE RAILWAY. WORKS EFFECTING SAFETY OF THE OPERATIONAL NR RAILWAY LINE.
 - NR - 3.04: REMOVAL/PRUNING OF TREES ON THE EA BERM AND NR EMBANKMENT - STABILITY OF THE EMBANKMENT COULD BE EFFECTED.
 - PF - 6.01: EXCAVATIONS / CONSTRUCTION IN THE VICINITY OF BURIED SERVICES - DAMAGING EXISTING POWER, COMMUNICATIONS, SEWER, WATER AND GAS SERVICES. REFER TO DESIGNERS RISK ASSESSMENT (ENVIMSE100377-VBA-XX-ZZ-RA-Z-0031-S3-P01-K0500-EA3-LOD3-LEHES DRA)

- MAINTENANCE/OPERATION**
- NR - 3.02: IMPOUNDING WITHIN THE FSA - INCREASED WATER LEVEL CAUSING EROSION AND INSTABILITY TO THE EA BERM AND NR EMBANKMENT. REFER TO DESIGNERS RISK ASSESSMENT (ENVIMSE100377-VBA-XX-ZZ-RA-Z-0031-S3-P01-K0500-EA3-LOD3-LEHES DRA)

- DECOMMISSIONING/DEMOLITION**
- REFER TO DESIGNERS RISK ASSESSMENT (ENVIMSE100377-VBA-XX-ZZ-RA-Z-0031-S3-P01-K0500-EA3-LOD3-LEHES DRA)
- It is assumed that all works will be carried out by a competent contractor working, where appropriate, to an approved method statement

- NOTES:**
1. ALL DIMENSIONS ARE IN MILLIMETRES UNLESS NOTED OTHERWISE
 2. ALL LEVELS ARE TO METRES ABOVE ORDNANCE DATUM (mAOD). UNLESS NOTED OTHERWISE.

- LEGEND**
- ALIGNMENT OF FLOOD WALL. TOP OF WALL = 29.50mAOD
 - EXISTING FENCE
 - CONTOUR 29.0mAOD
 - LOCAL RAISING OF EXISTING BERM

REFERENCE DRAWINGS

ENVIMSE100380-VBA-IP01-LH-DR-C-4216 PAULS FARM PUMP STATION

1m 0m 1m 2m 3m
Scale 1:50

10m 0m 10m 20m 30m 40m 50m 60m 70m
Scale 1:1000

PO2	05.08.19	NMOWL AMENDED	AK	OWK	CH
P01	13.03.19	ISSUED FOR CLIENT REVIEW	MS	CA	SA
Rev.	Date	Description	By	Chk'd	App'd

FOR CLIENT REVIEW S8

VBA Joint Ventures Limited
Woodcote Grove
Ashley Road
Epsom
Surrey
KT185BW
Tel: +44 (0)1925 238000
Fax: +44 (0)1925 238500
www.atkinglobal.com



LEIGH EXPANSION AND HILDENBOUROGH EMBANKMENT SCHEME

PAULS FARM ACCESS ROAD PLAN

Scale	AS SHOWN	Designed	-	Drawn	MS	Checked	CA	Authorised	SA	
Original Size	A1	Date	13/03/19	Date	13/03/19	Date	13/03/19	Date	13/03/19	
Drawing Number	ENVIMSE100377-VBA-ZZ-NR04-DR-C-4205								Revision	P02